

## Spare Parts for XM60 SmartLine Radar Level Meter XM60

## Model Selection Guide



Supply the original instrument model code and serial number when ordering

### Instructions

Select the desired key number. The arrow to the right marks the selection available.  
Make the desired selections from Tables I through V using the column below the proper arrow. A dot (•) denotes availability.

Table	I	II	III	IV
XM60	- 4	---	---	--- V ---

### KEY NUMBER

XM60

### Description

### Availability

### Selection

XM60 ↓

### TABLE I

Level Meter Code

4 •

### TABLE II

<b>Approvals</b>	Without ATEX II G/D 1, 1/2, 2 Ex ia IIC T6 ATEX II G/D 1/2, 2 Ex d ia IIC T6 FM IS Cl. I Div. 1 Gr. A-G Dual Seal FM XP Cl. I Div. 1 Gr. A-G Dual Seal NEPSI Ex ia IIC T3...T6 NEPSI Ex dia IIC T3...T6 ECEX Zone 0 Ex ia IIC T3...T6, Ex iaD 20 IECEX Zone 0/1 Exd [ia] IIC T3...T6, Ex tD [iaD] A21/20 CSA IS Cl. I Div. 1 Gr. A-G Dual Seal CSA XP Cl. I Div. 2 Gr. A-G Dual Seal	<b>Approval selection must match the approval designation of the original meter</b>	0 ----	a	
			2 ----	a	
<b>Material Process Connection and Antenna</b>	Without 316L / 1.4404 + Drop PTFE (40 bar) - Drop PP (16 bar)		3 ----	d	
			6 ----	c	
<b>Antenna</b>	Without	<b>Drawing Reference</b>	7 ----	c	
	Antenna DN 80 dia. 75 mm (2.95 inch) - long - with purging system		(c + d)	E ----	a
	Antenna DN 100 dia. 95 mm (3.7 inch) - long - with purging system		(c + e + f)	F ----	d
	DROP PTFE DN 80 long (Ø 75 mm / 2.95 inch)		(m)	M ----	a
	DROP PP DN 80 long (Ø 75 mm / 2.95 inch)		(l)	N ----	d
	Drop PP DN 150 (Ø 144mm/5,67 inch) - long		(n)	H ----	c
	Sheet metal horn DN 80 (Ø 75 mm / 2.95 inch) - long - with purging system		(h)	K ----	c
	Sheet metal horn DN 100 (Ø 95mm/3,7 inch) - long - with purging system		(i)	0 ----	•
	Sheet metal horn DN 150 (Ø 140 mm/5.5 inch) long + purging system		(j)	1 ----	•
	Sheet metal horn DN 200 (Ø 190 mm/7.48 inch) long + purging system		(k)	2 ----	•
				3 ----	e
<b>Antenna Extension</b>	Without		4 ----	w	
	Extension 105 mm (4.13 inch)	(g) for Horn or (o) for Drop	P ----	l	
	Extension 210 mm (8.26 inch)	(g) for Horn or (o) for Drop	S ----	m	
	Extension 315 mm (12.4 inch)	(g) for Horn or (o) for Drop	T ----	p	
	Extension 420 mm (16.54 inch)	(g) for Horn or (o) for Drop	V ----	h	
	Extension 525 mm (20.67 inch)	(g) for Horn or (o) for Drop	W ----	w	
	Extension 630 mm (24.80 inch)	(g) for Horn	X ----	b	
	Extension 735 mm (28.94 inch)	(g) for Horn	Y ----	g	
	Extension 840 mm (33.07 inch)	(g) for Horn	0 ----	•	
	Extension 945 mm (37.20 inch)	(g) for Horn	1 ----	•	
	Extension 1050 mm (41.34 inch)	(g) for Horn	2 ----	•	
	Flange plate protection (PP drop) for DN 80/100, 3" & 4", 80A & 100A	(q) with antenna	3 ----	•	
	Flange plate protection (PP drop) for DN 150, 6" & 8"	(q) or (s)	4 ----	•	
	Flange plate protection (PTFE drop) for DN 80/100, 3" & 4", 80A & 100A	(r)	5 ----	•	
	Flange plate protection (PTFE drop) for DN 150, 6" & 8"	(r)	6 ----	•	

TABLE II

<b>Feedthrough / Temperature / Sealing Gasket</b>	Without	<ul style="list-style-type: none"> <li>----- 0 •</li> <li>----- 1 •</li> <li>----- 2 •</li> <li>----- 3 •</li> <li>----- 4 •</li> <li>----- 5 •</li> <li>----- 6 •</li> <li>----- F •</li> <li>----- G •</li> <li>----- H •</li> <li>----- K •</li> <li>----- X •</li> </ul>
	Standard: -40°C (-40°F)...+150°C (302°F), 40 bar (580 psi) max. / FKM/FPM Standard: -20°C (-4°F)...+150°C (302°F), 40 bar (580 psi) max. / Kalrez 6375 Dual: Metaglas / -30°C (-22°F)...+150°C (302°F), 40 bar (580 psi) / FKM/FPM Dual: Metaglas / -20°C (-4°F)...+150°C (302°F), 40 bar (580 psi) / Kalrez 6375 Standard: -50°C...+150°C / EPDM Dual Metaglas: -30°C...+150°C / EPDM Standard / -40°C...+200°C / FKM/FPM (distance piece included) Standard / -20°C...+200°C / Kalrez 6375 (distance piece included) Metaglas® / -30°C...+200°C / FKM/FPM (distance piece included) Metaglas® / -20°C...+200°C / Kalrez 6375 (distance piece included) Standard / -40°C...+150°C / FKM FPM for Drop with flange and Non Ex applications	

TABLE III

<b>Process Connection - None</b>	Without	<ul style="list-style-type: none"> <li>0 0 0 _ •</li> <li>1 0 0 _ •</li> <li>4 0 0 _ •</li> <li>5 0 0 _ •</li> <li>6 0 0 _ •</li> <li>7 0 0 _ •</li> <li>8 0 0 _ •</li> <li>0 1 0 _ •</li> <li>0 6 0 _ •</li> <li>0 8 0 _ •</li> <li>0 A 0 _ •</li> <li>0 B 0 _ •</li> <li>0 C 0 _ •</li> <li>0 D 0 _ •</li> <li>0 0 3 _ •</li> <li>0 0 4 _ •</li> </ul>
	G1 1/2" A ISO229 DN 80 PN 40 Form B1 EN1092 DN 100 PN 16 Form B1 EN1092 DN 100 PN 40 Form B1 EN1092 DN 150 PN 16 Form B1 EN1092 DN 100 PN 40 Form B1 EN1092	
<b>Process Connection EN</b>	Without	<ul style="list-style-type: none"> <li>--- 0 •</li> <li>--- 3 h</li> <li>--- 4 s</li> <li>--- 5 s</li> <li>--- 6 r</li> <li>--- 7 t</li> <li>--- A r</li> <li>--- B r</li> <li>--- C t</li> <li>--- D r</li> <li>--- E k</li> <li>--- F s</li> </ul>
	1 1/2" NPT 3" 150 lb RF ASME B16.5 3" 300 lb RF ASME B16.5 4" 150 lb RF ASME B16.5 4" 300 lb RF ASME B16.5 6" 150 lb RF ASME B16.5 8" 150 lb RF ASME B16.5	
<b>Process Connection ASME</b>	Without	<ul style="list-style-type: none"> <li>--- 0 •</li> <li>--- 3 h</li> <li>--- 4 s</li> <li>--- 5 s</li> <li>--- 6 r</li> <li>--- 7 t</li> <li>--- A r</li> <li>--- B r</li> <li>--- C t</li> <li>--- D r</li> <li>--- E k</li> <li>--- F s</li> </ul>
	10K 80A RF JIS B2220 10K 100A RF JIS B2220	
<b>Process Connection Other</b>	Without	<ul style="list-style-type: none"> <li>--- 0 •</li> <li>--- 3 h</li> <li>--- 4 s</li> <li>--- 5 s</li> <li>--- 6 r</li> <li>--- 7 t</li> <li>--- A r</li> <li>--- B r</li> <li>--- C t</li> <li>--- D r</li> <li>--- E k</li> <li>--- F s</li> </ul>
	Terminal module (Non-Ex or Ex i) + screws n° 7+8 Backend (1 output) + High frequency module n° 1 + 6 HMI cover + cable (Aluminium) n° 14 Complete head with HMI (Aluminium) n° 7 + 8 + 9 + 10 + 11 + 12 + 14 + 15 Complete head with blind cover (Aluminium) n° 2 + 3 + 4 + 7 + 8 + 9 + 10 + 15 Complete housing with HMI + electronic module (Aluminium) n° 1 + 6 + thru 12 + 14 + 15 Complete head with HMI (Stainless steel) n° 7 + 8 + 9 + 10 + 14 + 15 Complete head with blind cover (Stainless steel) n° 2 + 3 + 4 + 7 + 8 + 9 + 10 + 15 Complete housing with HMI + electronic module (Stainless steel) n° 1 + 6 + 7 + 8 + 9 + 10 + 14 + Terminal module (Ex d) + screws n° 7+8 HMI cover + cable (Stainless steel) n° 14	

TABLE IV

<b>Output</b>	Without	<ul style="list-style-type: none"> <li>0 ___ •</li> <li>1 ___ •</li> <li>2 ___ •</li> </ul>
	1 Output 4...20mA (Hart) 2 Outputs 4...20mA (Hart) + 4...20mA	
<b>HMI (display &amp; keys)</b>	Without - No Display	<ul style="list-style-type: none"> <li>__ 0 __ •</li> <li>__ 1 __ •</li> <li>__ 2 __ •</li> <li>__ 3 __ •</li> <li>__ 4 __ •</li> <li>__ 5 __ •</li> <li>__ 6 __ •</li> <li>__ 7 __ •</li> <li>__ 8 __ •</li> <li>__ A __ •</li> <li>__ V __ •</li> </ul>
	English German French Italian Spanish Portugese Japanese Chinese (Mandarin) Russian	
<b>Version</b>	Honeywell	<ul style="list-style-type: none"> <li>--- 0 •</li> <li>--- 1 •</li> <li>--- 2 •</li> <li>--- 3 •</li> <li>--- 4 •</li> <li>--- 5 •</li> <li>--- 6 •</li> <li>--- 7 •</li> <li>--- 8 •</li> <li>--- A •</li> <li>--- B •</li> <li>--- C •</li> <li>--- D •</li> <li>--- E •</li> <li>--- F •</li> <li>--- G •</li> <li>--- H •</li> </ul>
	Without n°14 Stainless steel weather protection Cable entry M20x1,5 (ALU) M25x1,5 (SS) / without gland Screws + gaskets (kit for 1 unit) n° 3 + 5 + 7 + 9 + 11 Wiring compartment cover + gasket n° 10 + 11 Cable entry 1/2" NPT / without gland Cable entry G 1/2" / without gland (not for Sst housing) Cable entry M20x1,5 (ALU) M25x1,5 (SS) / plastic gland (Std: black, Ex ia:blue) n°6 Cable entry M20x1,5 (ALU) M25x1,5 (SS) / metal gland (Ex d devices only) n°6 Beige plastic sun shade n° 12+13 Blind cover + gasket + screws n° 2b + 3 + 5 Converter VIATOR RS232 / HART Converter USB / HART 2° PP slanted flange - DN80, 3", 80A (p) 2° PP slanted flange - DN100, 4", 100A (p) 2° PP slanted flange - DN150, 6" (p) 2° PP slanted flange - 8" (p)	

RESTRICTIONS

Restrictions Letter	Available only with		Not Available with	
	Table	Selection	Table	Selection
a			IV	___ 8
b	III	000_, 010_, 0C0_, 0D0_, 100_, 700_	II	___ P_, ___ R_, ___ S_, ___ T_
c			II	___ V_, ___ W_
			IV	___ A_
d			IV	___ 7
e			II	___ P_, ___ R_, ___ S_, ___ T_
g	III	000_, 100_, 0D0_	II	___ P_, ___ R_, ___ S_, ___ T_
h			II	3___, 7___, K___
			IV	0___
k	II	3___, 7___, K___	IV	0___
l	II	___ 0_, ___ 1_, ___ 2_, ___ 3_, ___ 4_, ___ 5_, ___ S_, ___ T_	II	___ F, ___ G, ___ H, ___ K
m	II	___ 0_, ___ 1_, ___ 2_, ___ 3_, ___ 4_, ___ 5_, ___ P_, ___ R_	II	___ F, ___ G, ___ H, ___ K
n			II	___ F, ___ G, ___ H, ___ K
p	II	___ 0_, ___ 1_, ___ 2_, ___ 3_, ___ 4_, ___ 5_, ___ P_, ___ R_	II	___ F, ___ G, ___ H, ___ K
	III	000_, 100_, 700_, 010_, 0C0_, 0D0_		
r			IV	00__
s			IV	_ 0__
t			IV	0___
w			II	___ P_, ___ R_, ___ S_, ___ T_
			III	400_, 060_, 080_, 003_

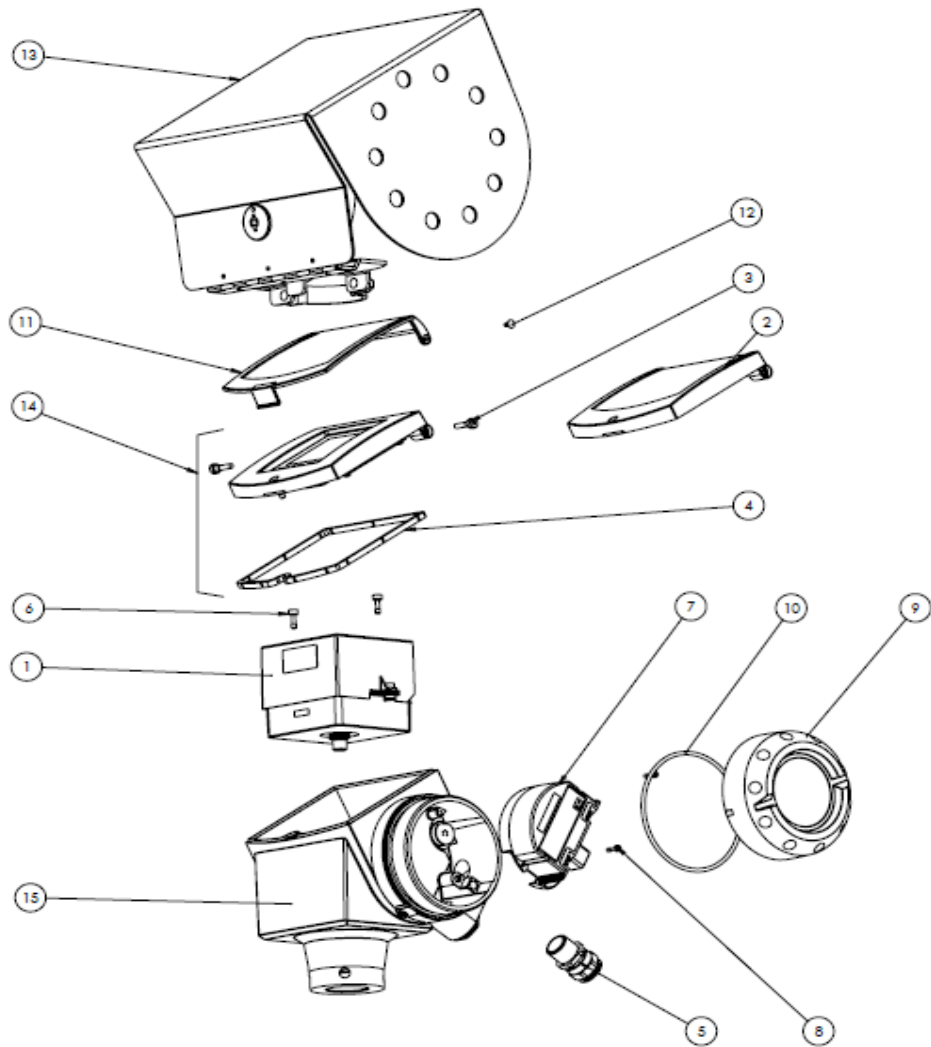

Rep.	Reference	Description	Quantity
1	4000659201	ELECTRONIC MODULE	1
2	F3177240100	BLIND COVER	1
3	F3177340000	SCREWS FOR COVER	2
4	F3177420000	COVER GASKET	1
5	See TABLE 1	CABLE GLAND	1
6	F3177360100	SCREW FOR BACK END ELECTRONIC	2
7	See TABLE 2	TERMINAL MODULE	1
8	F3177350000	SCREWS FOR TERMINAL MODULE	2
9	F3177260100	WIRING COMPARTMENT COVER	1
10	F5091150000	WIRING COMPARTMENT COVER SEAL	1
11	F3179980000	BLUE PLASTIC SUN SHADE	1
12	F3179990000	PINS FOR PLASTIC SUN SHADE	2
13	F2096340000	STAINLESS STEEL WEATHER PROTECTION	1
14	XF634000000050100	HMI COVER AND CABLE (OW 6300)	1
14	XF704000000050100	HMI COVER AND CABLE (OW 7300)	1
15	F3177280100	HOUSING BODY	1

TABLE 1 CABLE GLAND	
F5091410200	Std (Black)
F5091410400	Exia (Blue)
F5080120200	ExD ia (Metallic)
TABLE 2 TERMINAL MODULE	
4000941901	Std 1 Output
4000941801	Std 2 Output
4000941901	Ex ia 1 Output
4000941801	Ex ia 2 Output
2139950100	Exd ia 1 Output
2139640100	Exd ia 2 Output
F2101740100	PA
F2101740200	FF

HORN DN80 HORN DN100 SHEET METAL HORN DN80 SHEET METAL HORN DN100 SHEET METAL HORN DN150 SHEET METAL HORN DN200

WITHOUT EXTENSION

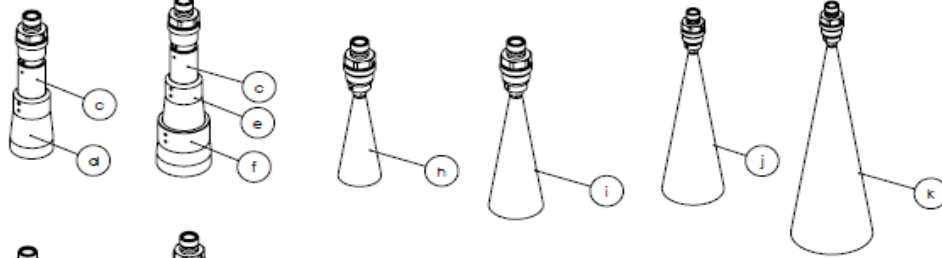

WITH EXTENSION

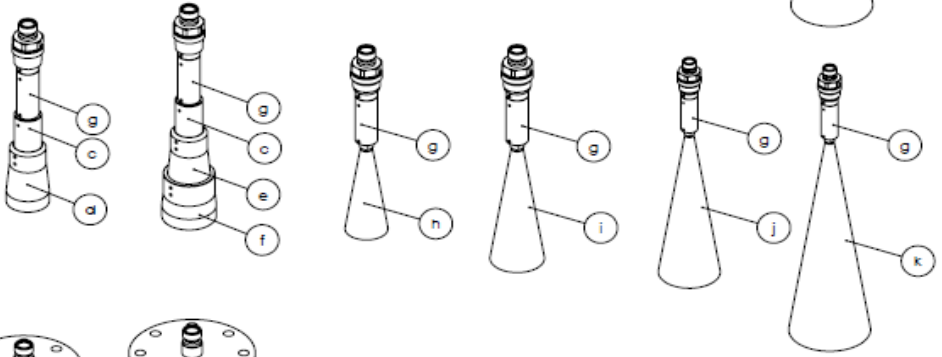

WITHOUT EXTENSION

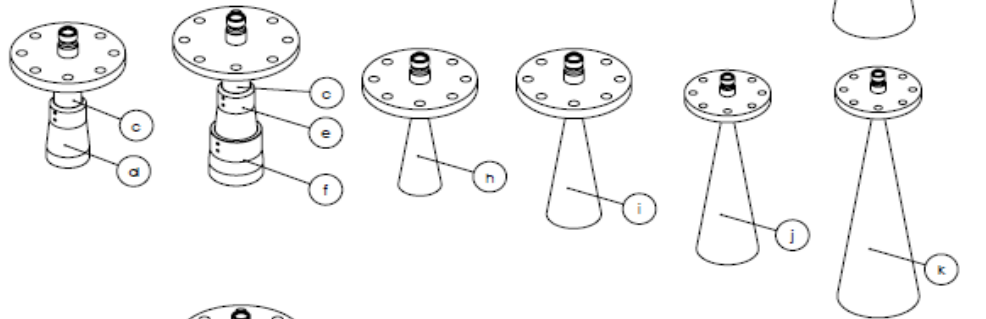

WITH EXTENSION

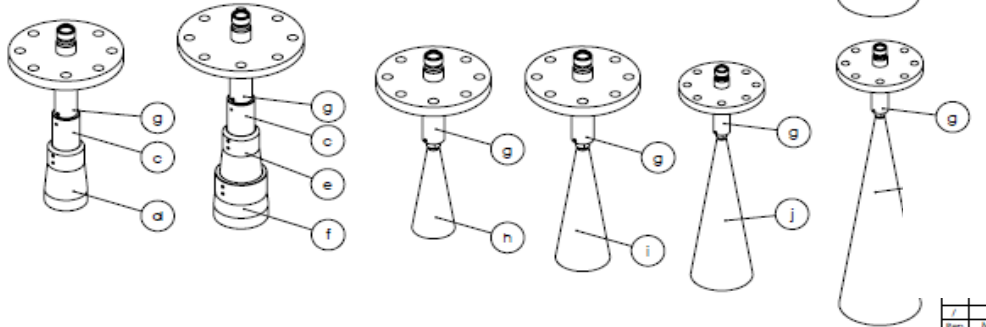

2° PP SLANTED FLANGE

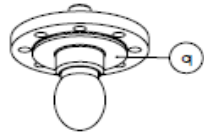

Table : 2° PP SLANTED FLANGE

Description	Reference
DN80 PN40	F3190190000
DN100 PN16	F3190190100
DN100 PN40	F3190190200
DN150 PN16	F3190190300
DN150 PN40	F3190190400
3" 150LBS	F3190220200
3" 300LBS	F3190220300
4" 150 LBS	F3190220400
4" 300LBS	F3190220500
6" 150LBS	F3190220600
6" 300LBS	F3190220700
8" 150LBS	F3190220800
80A 10K	F3190230200
100A 10K	F3190230300

Rep.	Description
c	ADAPTOR ANTENNA DN80
d	ANTENNA DN80
e	ADAPTOR ANTENNA DN100
f	ANTENNA DN100
g	EXTENSION ( N < 10 ) FOR HORN ANTENNA
h	SHEET METAL HORN DN80
i	SHEET METAL HORN DN100
j	SHEET METAL HORN DN150
k	SHEET METAL HORN DN200
l	DROP DN80 PP
m	DROP DN80 PTFE
n	DROP DN150 PP
o	EXTENSION (N<5) FOR DROP ANTENNA
p	2° PP SLANTED FLANGE
q	FLANGE PROTECTION WITH DROP DN80 PP
r	FLANGE PROTECTION FOR DROP DN80 PTFE
s	FLANGE PROTECTION WITH DROP DN150 PP

PP DN80 DROP  
WITH PROTECTION



PTFE DN80 DROP  
WITH PROTECTION

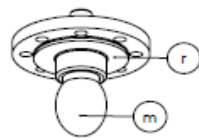

PP DN150 DROP  
WITH PROTECTION

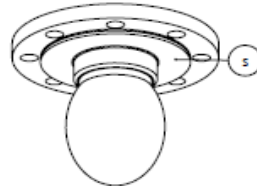

PP  
DN80 DROP

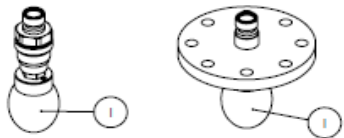

WITHOUT EXTENSION

PTFE  
DN80 DROP

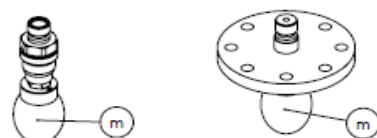

WITHOUT EXTENSION

PP  
DN150 DROP

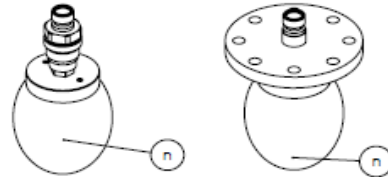

WITHOUT EXTENSION

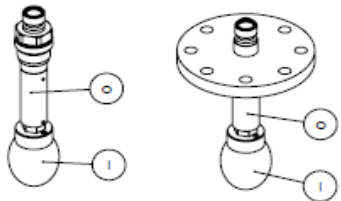

WITH EXTENSION

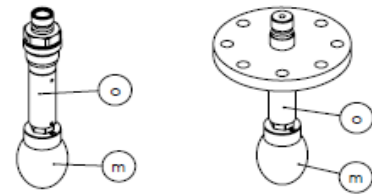

WITH EXTENSION

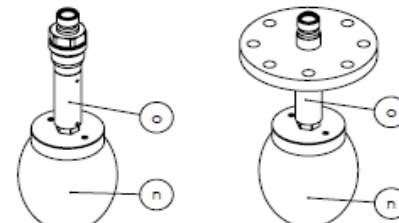

WITH EXTENSION

Rep.	Description	Quantity
a	ANTENNA DN40	1
b	ANTENNA DN50	1
c	ADAPTOR ANTENNA DN80	1
d	ANTENNA DN80	1
e	ADAPTOR ANTENNA DN100	1
f	ANTENNA DN100	1
g	EXTENSION ( N < 10 ) FOR HORN ANTENNA	1
h	SHEET METAL HORN DN80	1
i	SHEET METAL HORN DN100	1
j	SHEET METAL HORN DN150	1
k	SHEET METAL HORN DN200	1
l	DROP DN80 PP	1
m	DROP DN80 PTFE	1
n	DROP DN150 PP	1
o	EXTENSION (N<5) FOR DROP ANTENNA	1
p	2° PP SLANTED FLANGE	1
q	FLANGE PROTECTION WITH DROP DN80 PP	1
r	FLANGE PROTECTION FOR DROP DN80 PTFE	1
s	FLANGE PROTECTION WITH DROP DN150 PP	1
t	DN50 NEUMO BIOCONTROL	1
u	2" TRI-CLAMP	1
v	SMS 51	1
w	DN50 DIN 11851	1